

Balance

- WELCOME TO YOUR RETREAT! -



Cabins

After a long day of adventures, our cabins are the perfect place to relax and recharge! Each of our cabins has 36 beds for a total of 72 guests. Below, you'll find a layout of one of our cabins. Features: Air-conditioned, tankless water heaters, cubbies for both toiletries and luggage, changing stalls in each shower, front porch on both cabins with seating and ping-pong tables.

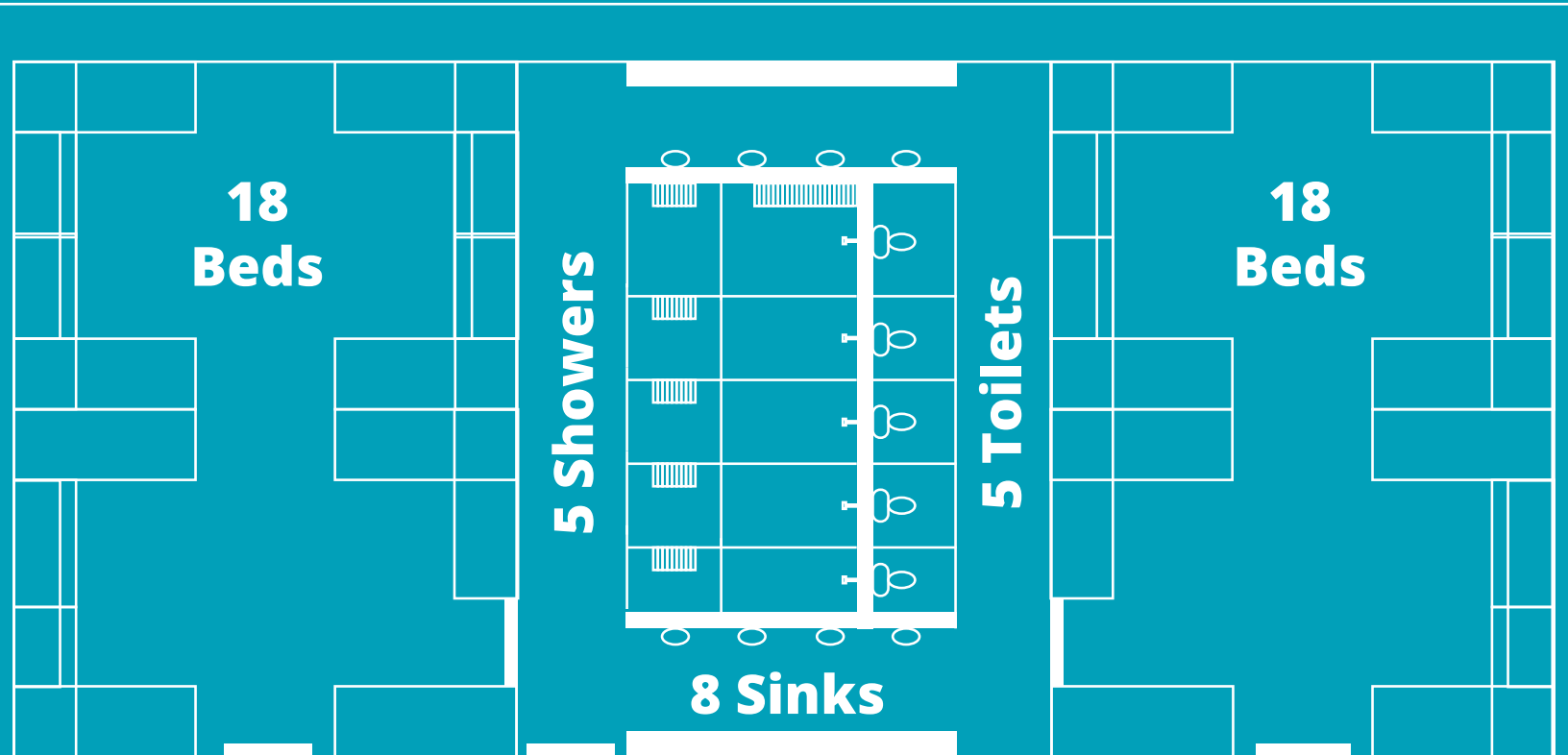

Multi-Purpose Building

Consider this your personal meeting space! The Multi-Purpose Building is where you'll enjoy your meals, conduct meetings and also is a great location for relaxation in the evenings. Our 1,200 SF Multi-Purpose Building is: air conditioned, has seating and tables for 72 guests, a warming kitchen and Business Class Wi-Fi.

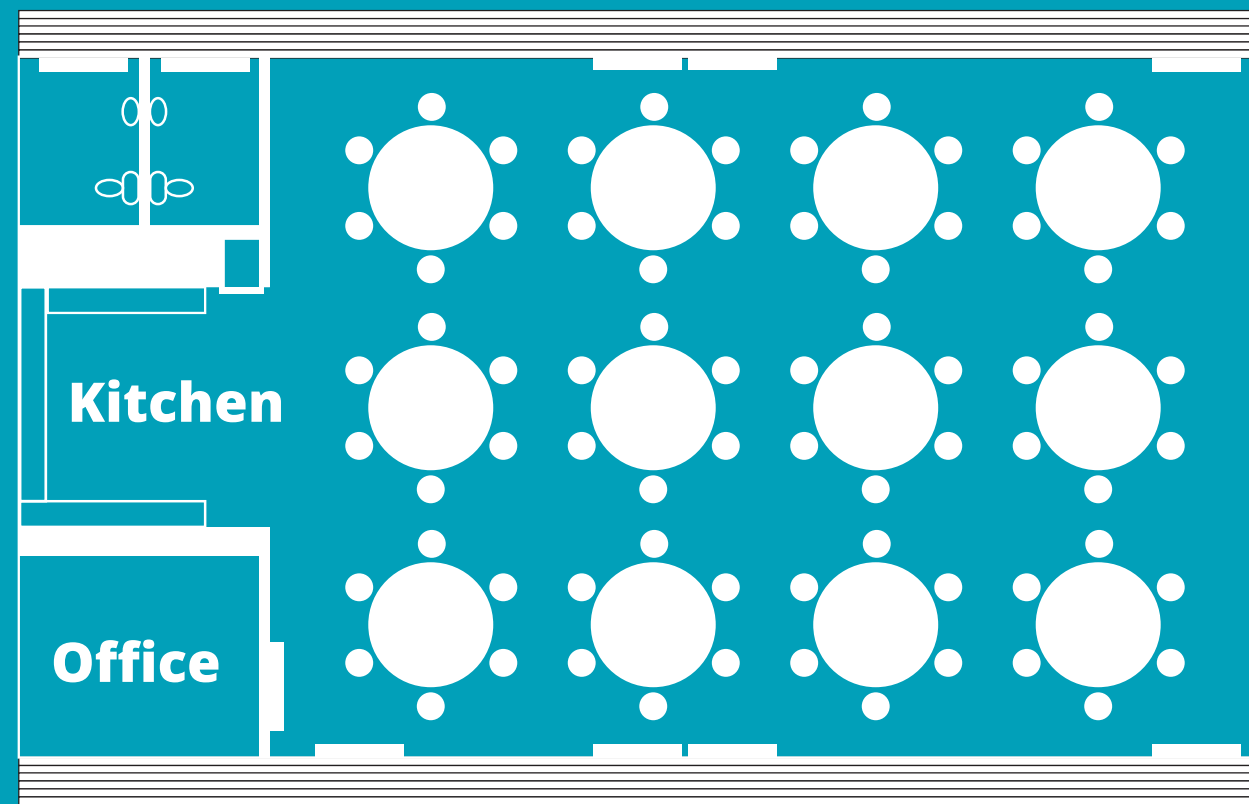

- 12 Tables
- 72 Chairs
- Oven
- Refrigerator
- Freezer
- 2 Restrooms
- WiFi
- Air-Conditioned



Included in Your Stay

The following activities are included with your retreat at Canaan!



DISC GOLF



HIKING TRAILS



SPORTS FIELDS



FIREPIT



ACCESS TO FISHING



COVERED BASKETBALL COURT

Embrace the Adventure

Want even more adventure during your retreat?
Consider adding the following activities!



ARCHERY TAG



CATAWBA TOWER



HIGH ADVENTURE COURSE



ZIPLINE TOUR



KAYAKING



TEAM BUILDING

Everything Else

We are so excited that you have chosen Camp Canaan as your retreat or day event destination! Whether you're a novice group leader or a refined expert, everyone can appreciate some tips!

What to Pack

Here is a quick list of some of the most important items to remember for your retreat at Canaan!

- Season specific clothing
- Closed toe shoes
- Reusable water bottle
- Sleeping bag and pillow
- Bath towels and toiletries
- Flashlight, camp chair,
- Bug spray, etc. (if desired)
- Journal
- Bathing suit
- Sports Balls

Prepare Your Guests

For a full list of our Policies & Procedures, please click on the following link:

<https://www.cognitoforms.com/CampCanaan1/CampCanaanContractPoliciesProcedures>

Arrival

Our typical arrival time for groups is 3:00 pm. Upon arrival, head to the Multi-Purpose Building where a Canaan Staff member or director will process your retreat waivers and balance of payment prior to the start of your retreat. A short orientation and welcome will follow after your groups check in and registration is complete.

Departure

Departure time is 12:00 noon. Upon departure make sure that all used kitchen facilities are clean and any food/ condiments are taken back with you. All trash from your eating area should be properly disposed of in the outside dumpster. Before departure a staff member will check in with your group and answer any questions and to see you off. Be sure to book your next visit before departing!

OUR 100 ACRE ISLAND

CAMP CANAAN | 3111 Sand Island Rd. Rock Hill, SC 29732 | 803.327.6932 | campcanaan.org



